

Adper™ Prompt™ Self-Etch Adhesive

Better by design! Bonds dentin, cut enamel and uncut enamel without need for a separate etch step.

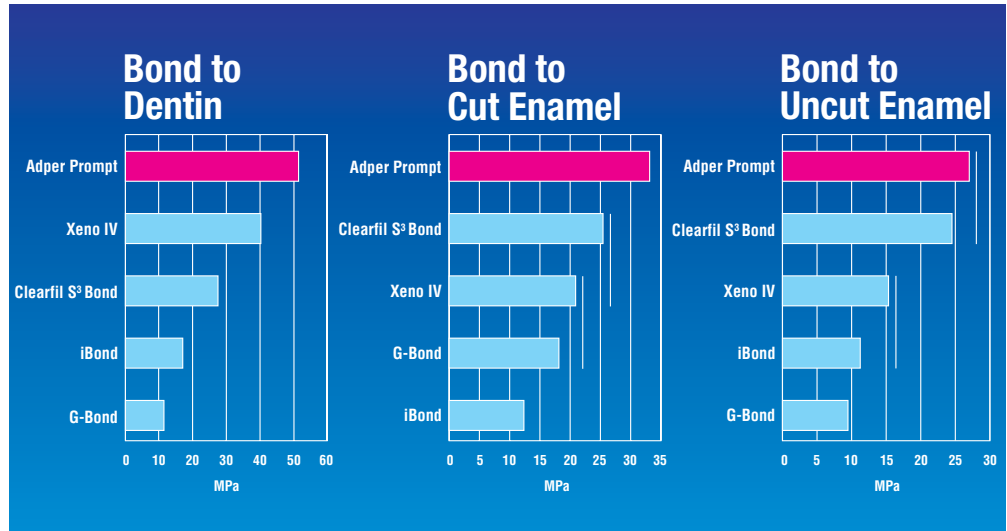

A deeper etch pattern strengthens bonding performance to enamel. Test results confirm Adper Prompt adhesive's microtensile bond strength. Vertical white lines connect products where bond strength is statistically similar. [Source: Independent microtensile testing courtesy of Dr. Jorge Perdigao, UNIVERSITY OF MINNESOTA]

A design difference you can see

The lower pH of Adper Prompt Self-Etch Adhesive provides deeper etch patterns on cut and uncut enamel than competitive adhesives tested in this study. The result is proven bond strength without the need for a separate etch step.

The scanning electron microscopy images below compare the etch patterns of competitive adhesives on cut and uncut enamel.

Note that Adper Prompt adhesive provides sufficient etch even for bonding UN-CUT ENAMEL – while other adhesives require a separate etch step, per their instructions for use, to properly prepare intact enamel surfaces for bonding.

This important feature enhances Adper Prompt adhesive's versatility as a fast, convenient one-step adhesive that offers outstanding bond strength with very low incidence of post-operative sensitivity.

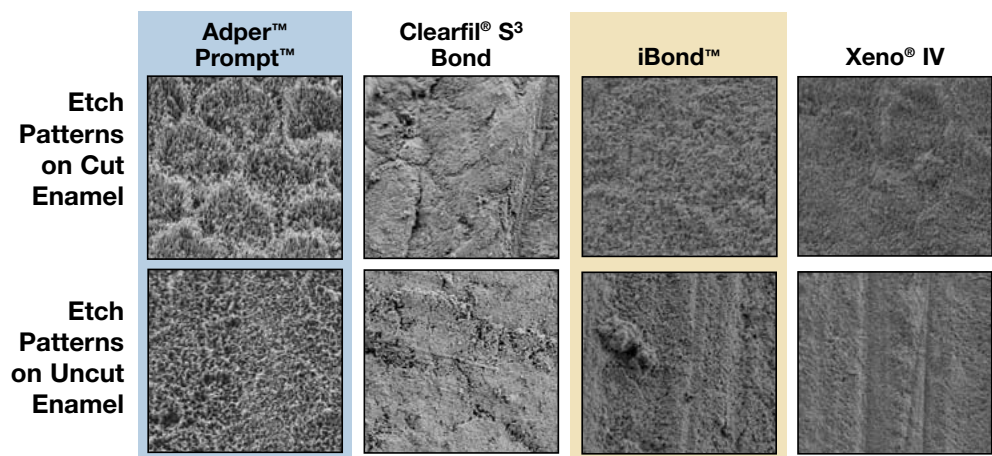

The lower pH of Adper Prompt adhesive provides a more pronounced etch than other self-etch adhesives, allowing for use on UN-CUT enamel without a separate acid-etch step.

Adper™



- Bonds to dentin, cut enamel and uncut enamel without separate etch step
- Clinically proven
- Very low incidence of post-operative sensitivity
- Desensitizes hypersensitive root surfaces
- Simplifies sealant technique
- Innovative, disposable L-Pop™ unit-dose delivery, or vial delivery system

It's no accident ... Adper™ Prompt™ Self-Etch Adhesive etches UNCUT enamel BY DESIGN

One of the challenges inherent in a self-etch adhesive is that the low pH required for etching ability is contrary to the chemical stability of aqueous self-etching methacrylate solutions. *Most self-etch adhesives, including the new one-bottle systems, are either not indicated for use on uncut enamel – or require a separate acid etch step in order to bond to uncut enamel.*

3M ESPE designed Adper Prompt adhesive to avoid that constraint. **So by design, it can be more acidic than other products, allowing it to be indicated for dentin, cut enamel and UNCUT enamel.** That makes it an effective solution for minimizing the possibility of marginal discoloration as well as simplifying the sealant bonding technique by eliminating the phosphoric etch step.

pH Measurement of Self-Etch Adhesive Systems

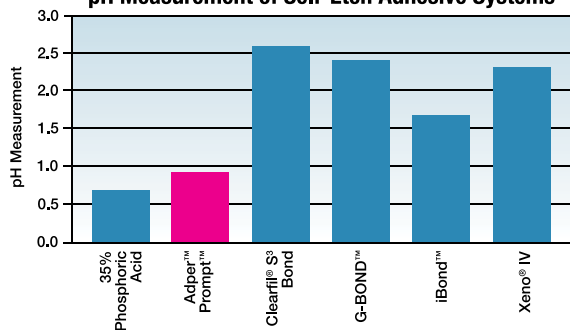

Source: 3M ESPE Internal data

- **Adper Prompt adhesive:** The lower pH etches uncut enamel.
- **Clearfil S³ Bond:** Instructions require etching uncut enamel.
- **G-Bond:** Instructions require etching for uncut enamel and etching is recommended for cut enamel.
- **iBond:** Instructions require intact enamel and sclerotic dentin must be conditioned separately with phosphoric acid.
- **Xeno IV:** Instructions state it is less effective on uncut enamel.

L-Pop™ unit-dose option is convenient and easy to use

Adper Prompt Self-Etch Adhesive is available in 3M ESPE's unique L-Pop unit-dose delivery option. There's no measuring, mixing or cleanup. The unique design is self-contained — holding the adhesive and brush-tip applicator.

Adper Prompt adhesive is also available in a vial delivery system to accommodate multiple restorations.

Easier to Activate. The L-Pop delivery system allows for easier flow of material from one chamber to the next. When the material moves from the red chamber to the yellow chamber, the indentation in the yellow chamber pops up to show that the material has properly transferred.

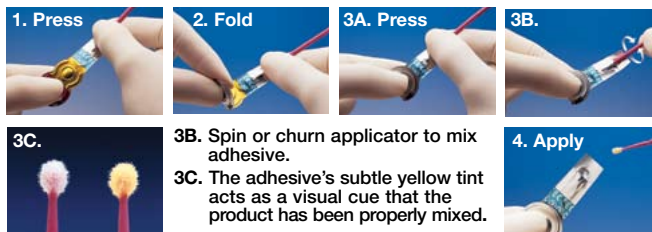

Ordering Information



Adper™ Prompt™ L-Pop™ Self-Etch Adhesive (unit-dose delivery)



Adper™ Prompt™ Self-Etch Adhesive (vial delivery system)

Item Number Product Information

3M™ ESPE™ Adper™ Prompt™ L-Pop™ Self-Etch Adhesive

41923	Mini Pack – 20 L-Pop Applicators with XS Brushes ¹
41925	Refill Pack – 40 L-Pop Applicators ¹
41926	Giant Pack – 100 L-Pop Applicators ¹
41927	Bulk Pack – 200 L-Pop Applicators ¹
41928	Economy Pack – 500 L-Pop Applicators ¹

3M™ ESPE™ Adper™ Prompt™ Self-Etch Adhesive

41930	Adper Prompt Self-Etch Adhesive Introductory Kit ¹ Vial introductory kit contains: 6ml Liquid A ² (41933), 2ml Liquid B ² (41934), 50 Disposable Mixing Wells ² (3401W), 50 Applicator Brushes (Red) ² (41929)
41933	Refill Liquid A – 6ml
41934	Refill Liquid B – 2ml
41929	Applicator Brushes (Red) – 50 Refill Pack
41904	XS Applicator Brushes (Yellow) – 50 Refill Pack

¹MSDS available. Call 1-800-634-2249.

²Also available separately.

3M ESPE Technical Hotline 1-800-634-2249

www.3MESPE.com



Dental Products

3M Center
Building 275-2SE-03
St. Paul, MN 55144-1000
USA
1-800-634-2249

3M Canada

Post Office Box 5757
London, Ontario N6A 4T1
Canada
1-800-265-1840 ext. 6229

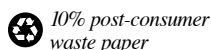

© 3M 2006. All rights reserved.

Printed in USA

3M, ESPE, Adper, Prompt and L-Pop are trademarks of 3M or 3M ESPE AG. Used under license in Canada. Clearfil is a trademark of Kuraray Dental. iBond is a trademark of Heraeus Kulzer. G-Bond is a trademark of GC America. Xeno IV is a registered trademark of Dentsply Caulk.
70-2009-3772-3